

CONCRETE VIBRATOR

This light and dependable vibrator is set up to remove bubbles from poured concrete. Comfortable for the operator with the support strap and it's easy to use quickly under all conditions.

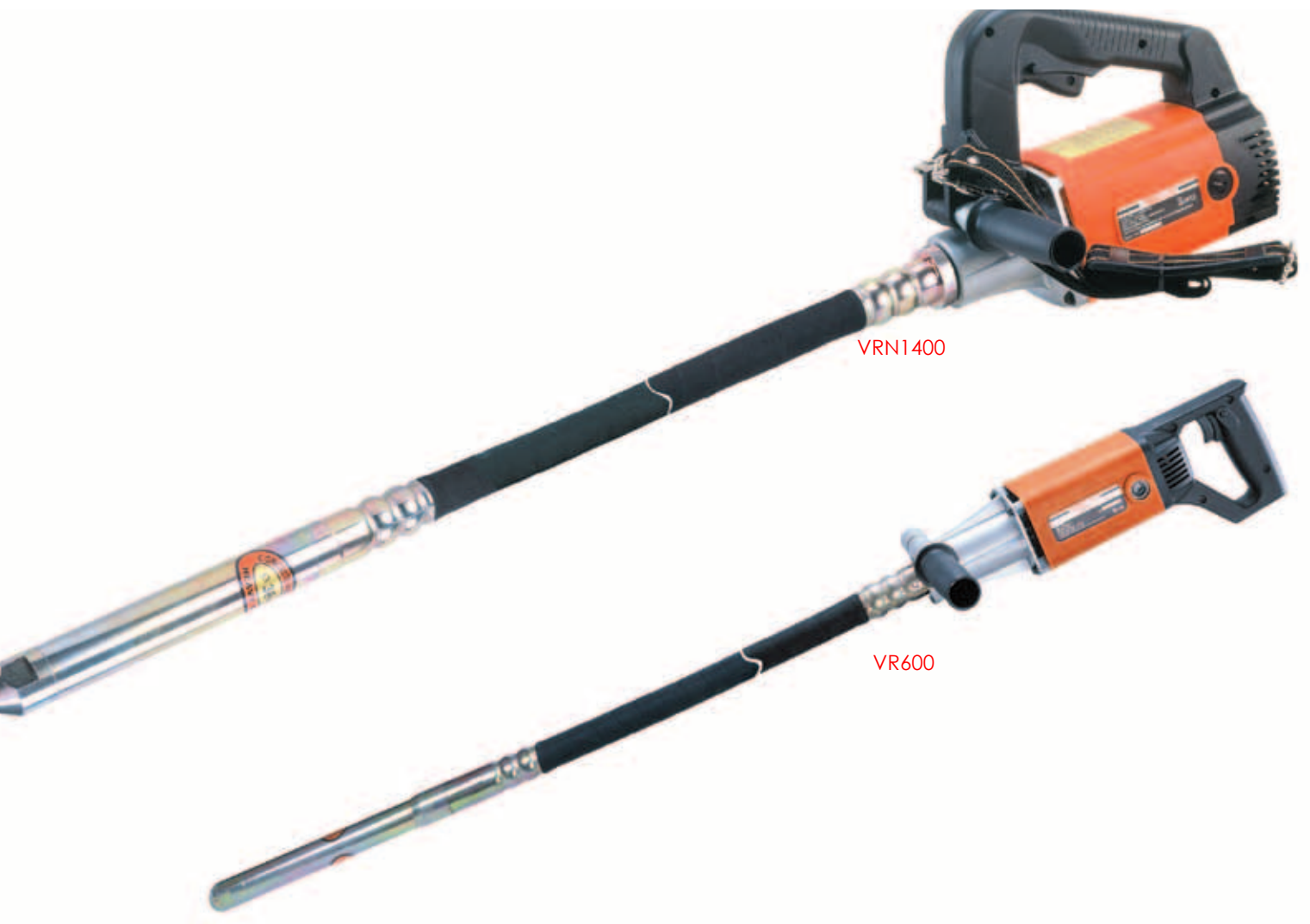

VRN1400

VR600

OPTIONAL ACCESSORIES

■ **Concrete Vibrator Shafts - Flexible Type** (Please indicate desired shaft when ordering.)

Size	Part Number	Size	Part Number
AZ017 ø28mm x 1000mm	305-00077-000-001	AZ018 ø38mm x 1000mm	305-00077-000-004
AZ013 ø28mm x 1780mm	305-00077-000-002	AZ014 ø38mm x 1780mm	305-00077-000-005
AZ019 ø28mm x 3000mm	305-00077-000-003	AZ015 ø38mm x 3000mm	305-00077-000-006



Model	VRN1400	VR600
Power Input	1400W	600W
Voltage	110-120V~ 50-60Hz, 220-240V~ 50-60Hz	
No Load min-1	16,000	20,000
Vibration Rate	11,000 B/min.	14,000 B/min
Applicable Vibrator Shaft Types	AZ013, AZ014, AZ015, AZ017, AZ018, AZ019	AZ017, AZ013
Soft Start	With	Without
Net Weight (Motor unit only)	4.3 kg (9.5 Lbs)	2.45 kg (5.4 Lbs)

STANDARD ACCESSORIES

VRN1400

- * Side Handle
- * Safety Belt

VR600

- *Side Handle

ROTARY BUSH HAMMER

The specialized tool for roughening smooth stone surfaces. Perfect for creating non-slip strips on stone stairs.

This Rotary Bush hammer is designed for texturing and roughening of smooth stone surfaces. This is especially important for performing operations to create anti-slip surfaces on stone floors and steps. The parallel guide allows the creation of perfectly straight lines. There are different mounting positions for the Bush hammer Roll Tool Holders to create different working widths.

The 1200 W motor is equipped with variable full wave feedback electronic speed control for an even texture. No matter the load, the motor keeps the same even speed.

Effective and convenient dust extraction system for a healthy and mess-free job.

Includes a bayonet adaptor end to allow connection to your vacuum cleaner hose.

Comfortable handles help keep vibration away from the hands.



Plastic Carry Case

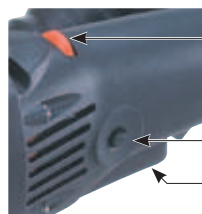

Speed control thumb wheel
with Feedback speed
stabilization

Lock Button

Trigger Switch



Bayonet Adaptor End

High efficiency 1200W motor with
variable full-wave feedback
electronic speed control

Ergonomic downforce
handle



Effective dust extraction system
with swiveling bayonet mount

Fully adjustable parallel guide may be
mounted in the 9, 12, or 3 o'clock positions
for creating straight textured strips.

Bushhammer rolls (included) can be mounted to
create 51, 70, 96, or 116mm wide textured strips

■ BH92 Replacement Carbide Bushhammer Discs-(Set of 6)



Description

Bushhammer Roll Disc
(Each machine requires 6 pcs)

Part Number

302-02017-000-001

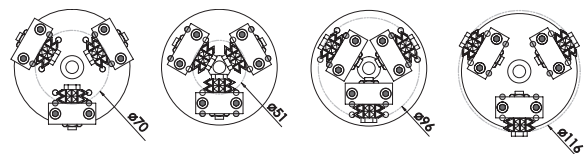

Plastic Carry Case
572mm x 362mm x 238mm

0299-0075-00100-011



Model	BH92
Power Input	1200W
Voltage	110-120V~ 50-60Hz, 220-240V~ 50-60Hz
No Load min ⁻¹	1600 - 3200
Bushhammering Diameters	51, 70, 96, or 116mm
Max. Cutting Depth	2.5mm
Soft Start	With
Net Weight	4.8 kg (10.56 Lbs)

STANDARD ACCESSORIES

- * Plastic Carry Case
- * Bushhammer Roll Discs (Set of 6)
- * Parallel Guide
- * Hex. Wrench M5
- * Bayonet Adaptor End
(For Connecting To Your Vacuum Cleaner Hose)

LONG-REACH DIAMOND GRINDER

The 125mm Long-Reach Diamond Grinder, It's really an exciting new tool with excellent possibilities in the market. It is extremely light in weight at only 3.8 kg for fatigue-free operation. Although it is light, the motor is very powerful at 1200W with feedback electronic speed stabilization. This allows the same speed to be maintained, no matter the load. It is very easy to control and almost all of the dust and debris are controlled by the vacuum system. This saves time and trouble in cleanup. The operation is the most comfortable possible, whether grinding floors from a standing position or grinding walls or ceilings without scaffolding or ladders. Huge amounts of both time and effort are saved



2-Axis Pivoting Grinding Head with Dust Shroud			
Hose 4M		Part Number	
Carry Bag		0203-0007-00004-001	
		308-01001-149-003	
Dust Collect Cover		203-0008-00004-007	
Outer Flange M14		302-04176-903-002	
Outer Flange 5/8"		302-04176-903-003	
Inner Flange 22.2mm		302-04222-903-001	(M14)
Inner Flange 25.4mm		302-04222-903-002	(M14)
Inner Flange 22.2mm		302-04222-903-004	(5/8")
Diamond Cup Wheels			
#50/60 Grit 22.2 mm		305-00072-000-007	
#50/60 Grit 25.4 mm		305-00072-000-008	
#80/100 Grit 22.2 mm		305-00072-000-009	
#80/100 Grit 25.4 mm		305-00072-000-010	
Aluminum pad M14		201-0045-00906-001	
Aluminum pad 5/8"		201-0045-00906-002	



- STANDARD ACCESSORIES**
- * Vacuum Hose 4M
 - * Carry Bag
 - * Bail Handle
 - * Face Spanner Wrench -78mm
 - * Wrench
 - * 125 mm Diamond Cup Disc (80/100 Grit)

Model	LG125
Power Input	1200W
Voltage	110-120V~ 50-60Hz, 220-240V~ 50-60Hz
No Load min ⁻¹	1700-3500
Length	1475 mm
Max. Capacity	125 mm
Arbor	7/8" (22.23mm)
Soft Start & Overload Protection	With
Net Weight	3.8 kg (8.36 Lbs) (Not including Diamond Cup Disc)



SCOURING MACHINE

- Versatile for removal of soft plaster surfaces; elastic protection on walls and floors; foam crests and adhesive remainders; asphalt and protective coatings for concrete; latex or oil paint on gypsum surfaces; and removal of impurities and contamination on concrete surfaces.
- Superior at grinding off irregularities and projections on plaster flooring and roughing, cleaning and smoothing out irregularities of aged concrete.
- Movable rubber base platform that bends and swivels according to the surface -putting less strain on the user's wrists.
- Ergonomically designed to decrease user fatigue.
- Side handle (able to attach to either side of the machine) improves handling of machine
- Dust free operation- attaches directly to standard vacuum hose.
- All three types of abrasive materials, carbide cutter discs, diamond cup grinding heads and TC grinding heads are easily replaced when worn out.



T-Arm for SM125 Scouring machine

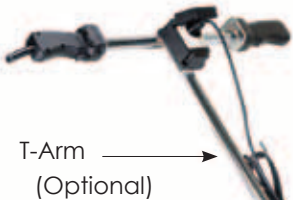

The T-Arm for the SM125 scouring machine allows the operator to work in an upright position for decreased fatigue and increased productivity.



Edge Cut-Out in gearcase

New cover which enshrouds the Edge Cut-Out when the Base is in place.

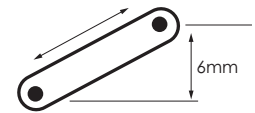

This will allow the accessory Diamond Grinding Head or Diamond Cup Wheel to reach right up to the edge. (It is not possible for the Scarifier Wheel to reach all the way to the edge).



Model	SM125
Power Input	1200W
Voltage	110-120V~ 50-60Hz, 220-240V~ 50-60Hz
No Load min ⁻¹	2800
Milling Head	125 mm
Milling Depth	1-6mm
Net Weight	5.4 kg (11.9 Lbs)

STANDARD ACCESSORIES

- * Side Handle
- * T-Wrench 13mm
- * Scarifier Wheel with Pyramid-Tip Cutter Discs
- * Wheel Puller
- * Face Spanner Wrench-93mm (for Scarifier Wheels)
- * Vacuum Hose End Adaptor
- * Plastic Carry Case

OPTIONAL ACCESSORIES

- * Overload Protection

■ Rotary Scarifier Wheels

Pyramid-Tip Cutter Discs (Standard)



The SM125 comes complete with a Rotary Scarifier Wheel with a set of Pyramid-Tip Carbide Cutter Discs. Ideal for very hard materials, it aggressively removes material and leaves behind a roughened surface. The adjustable shroud allows controlled depth.

Pyramid-Tip
Cutter Discs-(Set of 15)

Part Number
0299-0108-00000-001

OPTIONAL ACCESSORIES:

Flat-Tip Cutter Discs



For soft to medium materials
Leaves behind a smoother surface

Flat-Tip
Cutter Discs-(Set of 15)

Part Number
0299-0108-00000-002

■ Diamond Grinding Heads

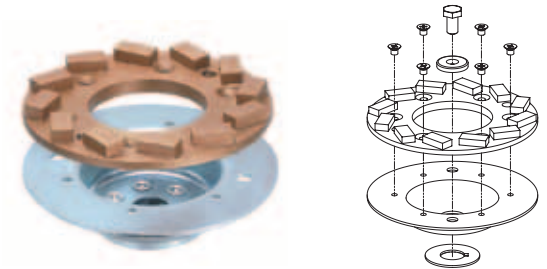

Diamond Cup Grinding Heads - Specially designed for use with the SM125, Optimized for 2,800 /min. (Mounting kit required.) In a range of grits.

Coarse grit heads grind more aggressively for removing coatings, leveling uneven areas or high spots on concrete surfaces. Progressively finer grit heads for a smoother surface.

Diamond Grinding Head Sets

(Includes Grinding Head Plus Mounting Cup Kit)

Grit	Part Number
40/50	0299-0022-00000-002
50/60	0299-0022-00000-003
60/80	0299-0022-00000-004
80/100	0299-0022-00000-005
100/120	0299-0022-00000-006

Diamond Grinding Heads (Grinding Head only)

Grit	Part Number
40/50	305-00072-000-002
50/60	305-00072-000-003
60/80	305-00072-000-004
80/100	305-00072-000-005
100/120	305-00072-000-006

Mounting Kits

Mounting Cup only	302-03100-903-001
Flat Head Screw (6 pcs required)	415-M05008080-080

■ Standard-Type Diamond Cup Wheels

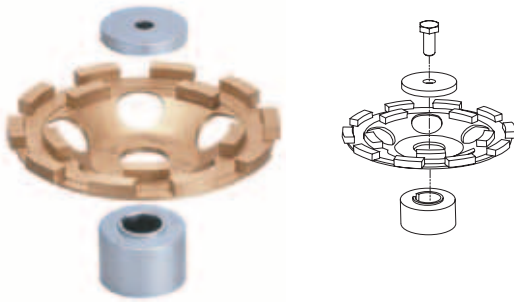

These discs are perfect for grinding concrete and similar materials. Coarse grit for aggressive removal. Fine grit for a smoother finish.

Diamond Cup Wheels

125mm discs with 7/8" (22.23mm) bore	Part Number
#30/40 Grit	305-00072-000-014
#50/60 Grit	305-00072-000-007
#80/100 Grit	305-00072-000-009

Mounting Accessories Required for Diamond Cup Wheels

(When ordering diamond cup wheel, 1pc of each spacer, outer flange, long arbor bolt, and 78mm face spanner wrench are required.)

Spacer	302-04180-903-001
Outer Flange	302-04181-903-001
Arbor Bolt-Long	401-M08035125-080
Face Spanner Wrench-78mm	302-04179-901-002

■ Face Spanner Wrench



■ T-Arm



T-Arm

Dimensions : 1120mm (L) x 780mm (W) x 115mm (H)

Weight: 3kg (6.6 Lbs)

■ Plastic Carry Case



Application	Outer Dimensions	Part Number
SM125	572mm x 362mm x 238mm	0299-0075-00100-001